

ISLE OF WIGHT PC USERS GROUP

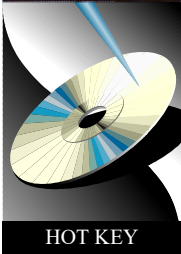

WWW.IWPCUG.ORG

MONTHLY JOURNAL SHOW EDITION

ISSUE 144 - December

In This Issue

meetings	2
Committee	3
Show Stands	4/5
Sponsors	6
Membership form	7
Location	8

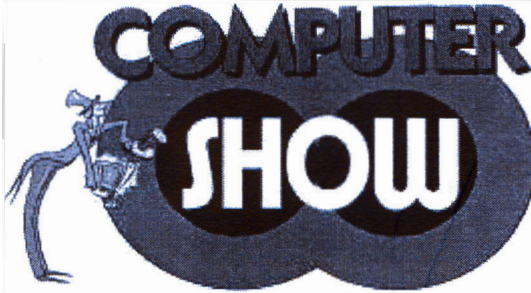

23rd November 2003

at

The Riverside Centre

Newport

10am to 4pm

Entrance: Adults £1

Children - Free



**Win a digital Camera
plus other prizes
in our raffle**

Organised by The Isle of Wight PC User Group

www.iwpcug.org



FUTURE MEETINGS

Sunday 23 Nov:	the big show	
3 Dec:	Software Painting	Cliff Maidment (organiser) with David Groom
17 Dec:	Christmas Party. A short talk and demo on making music using the MIDI system. There will be refreshments provided by the Riverside Centre afterwards. Partners are welcome	Lo Janus
7 Jan:	Windows Operating Systems -- The Basics	Dennis Linzmaier
21 Jan:	Computer Languages.	David Broughton
4 Feb:	ANNUAL GENERAL MEETING	3D modelling by Lo Janus
18 Feb	Introduction to Spreadsheets	David Broughton

Committee

Hon. President: Sir Norman Echlin

Chairman: Riverside Liaison: Sylvia Farley

Secretary: Christine Jenkins

Treasurer: Bob Groom

**Membership Secretary, Hot Key Distribution
& Database Manager:** Ray Boote

Vice Chairman & Webmaster: David
Broughton

Technical Consultant: Dennis Linzmaier

Journal Editor: Lo Janus (Co-opted member)

Disability Resources Coordinator: Helen
Edom

Show Organiser: Cliff Maidment

Assistant Show Organiser: David Groom

Committee Member: Brian Sexton

External Marketing: Derek Cox

Computability Representative: Roger Skid-
more (Co-opted member)

The Annual 2003 Computer Show

Main Hall

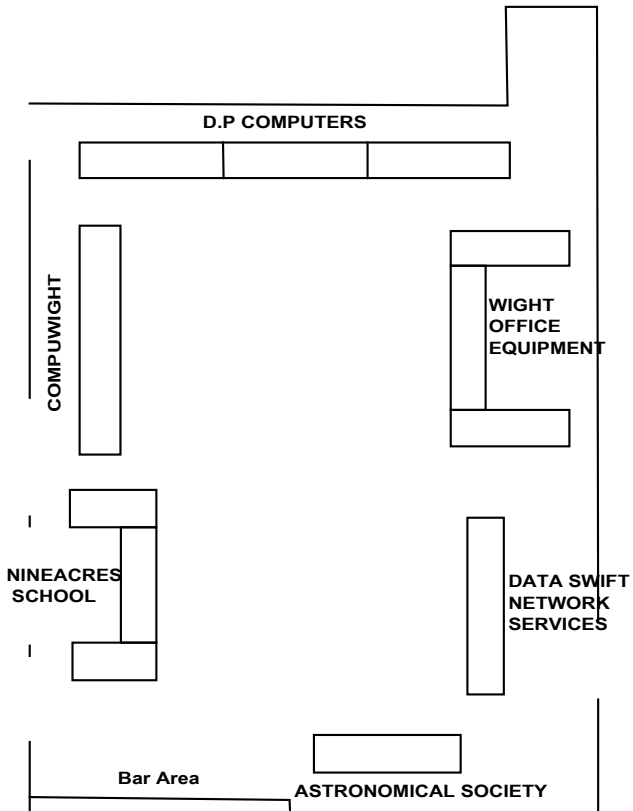

Hunnyhill Room

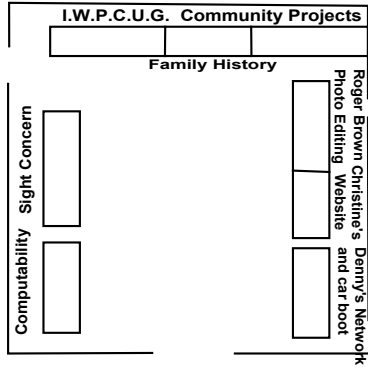

Workshop/ Lounge

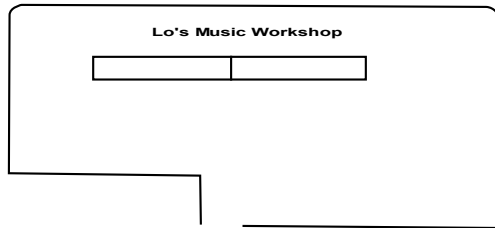

computers and music

ISLE OF WIGHT PC USER GROUP

The club meets on the first and third Wednesdays of the month at The Riverside Centre in Newport at 7.30 pm. All levels of experience and knowledge are welcome, from novice to expert.

MEMBERSHIP APPLICATION FORM

Membership is £12 per year or £1 for each month remaining in the year from the first of the current month.

Please send this completed form with your cheque (made payable to "The Isle of Wight PC User Group") to: The Membership Secretary, VARNA, East Hill Road, RYDE, IW, PO33 1LL.

Title _____ Initials _____ Surname _____

Forename _____ Date of birth ____/____/____

Address _____

Postcode _____ Home Phone _____

Job _____ Employer _____

E-mail address _____

Special Interests/favourite software _____

Associates: You may add here the name(s) of other person(s) as Associate Members who live at the same address (Associate Members do not pay a subscription) or an organisation that you will represent:

I hereby apply to become a member of the IW PC User Group. I agree to abide by the constitution.

DATA PROTECTION ACT, 1984. I agree that any of the details given on this form may be held on the Group's database and may be disclosed to any other member of the Group. I undertake that such information concerning another member of the Group will not be disclosed to a non-member except with the further permission of the member concerned.

Signature _____ Date ____/____/____

